

# QUICK GUIDE MICROFLOW SMART+

## Preparing machine

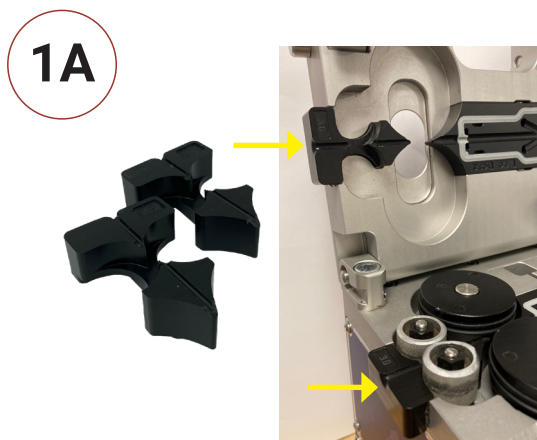

Insert inlet guides.

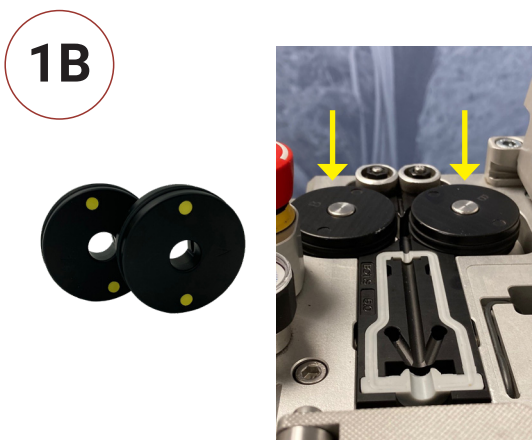

Insert wheels.

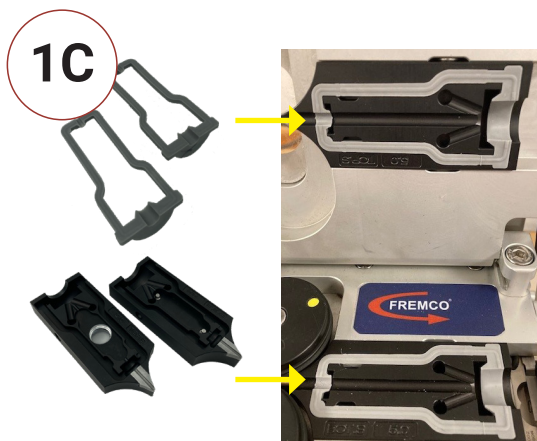

Place the gaskets into the adaptor plates, insert into the machine.

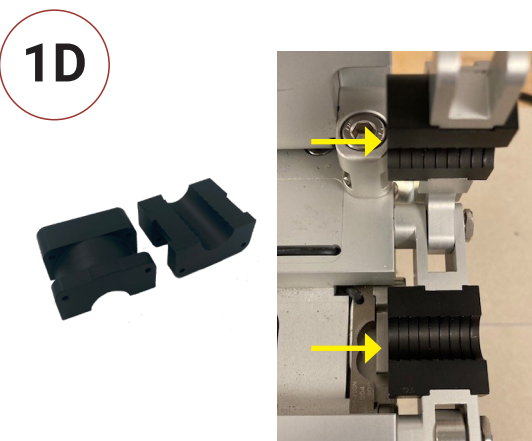

Insert duct clamps.

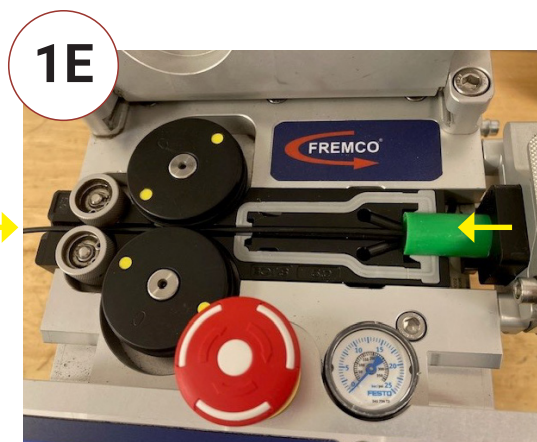

Insert cable and duct.

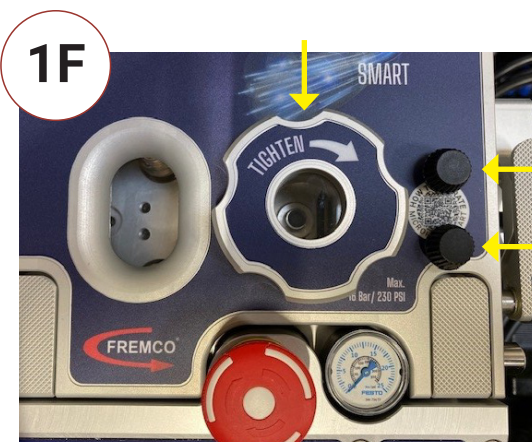

Close and tighten lid.

# QUICK GUIDE MICROFLOW SMART+

## Fiber blowing job in AUTO AIR MODE

2A

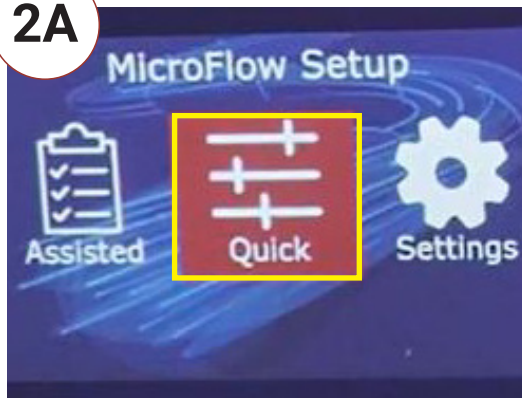

Follow the "Quick" setup.

2B



Use the **knob** for navigating and choosing settings. Turn left and right.

2C



**Confirm** the choices by pressing the knob down.

2D



For duct **preparation** before the job starts. (Blow sponges/lubricate etc.)

3

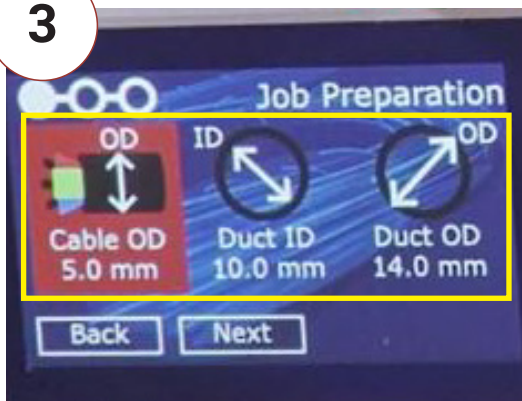

Enter the job preparation settings for **duct** and **cable**.

4

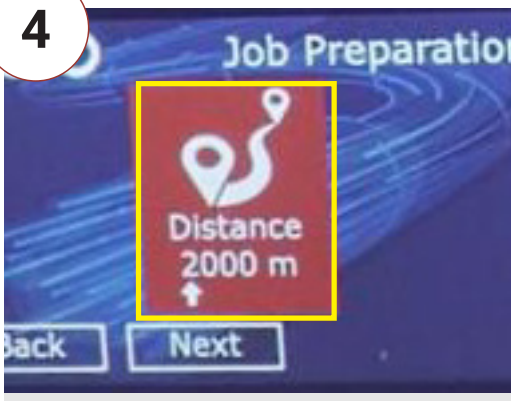

If unlimited distance is wanted, leave "**0000 m**" on the screen.

# QUICK GUIDE MICROFLOW SMART+

## Fiber blowing job in AUTO AIR MODE

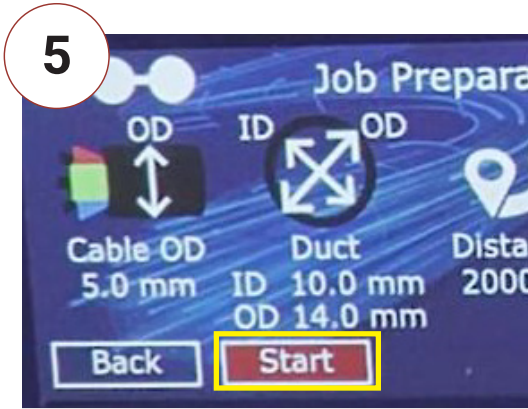

Chose and confirm **START** if settings showed on the screen is correct.

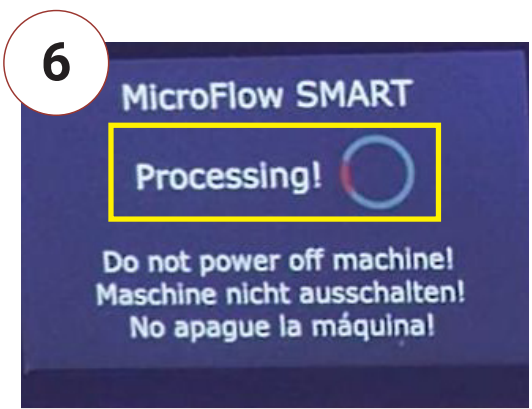

The machine is now **processing** the information given and will adapt to it.

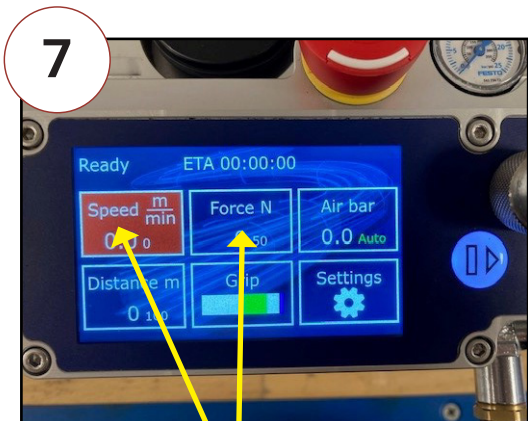

Decide what **speed** to use and how much **push force** is allowed.



Go to **Settings**.

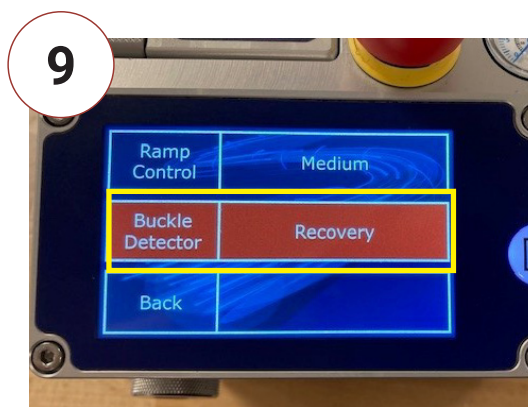

In the settings for Buckle Detector chose **Recovery**.

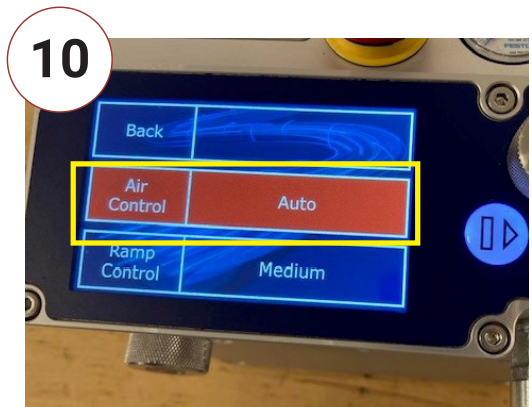

In the settings for Air Control chose **Auto**.

# QUICK GUIDE MICROFLOW SMART+

## Fiber blowing job in AUTO AIR MODE

11

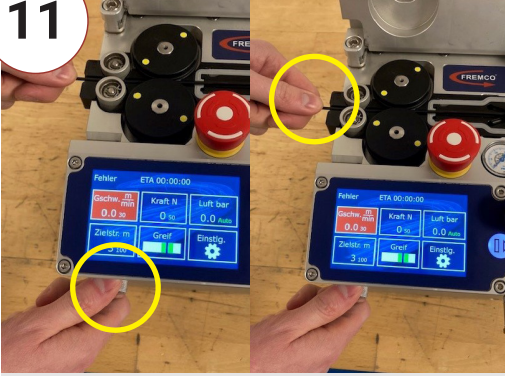

Make sure the **grip** is just enough to push the cable.

12

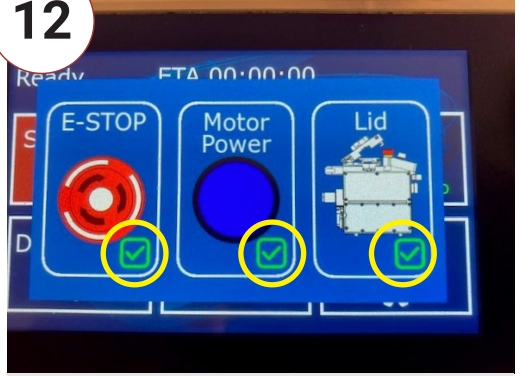

Make sure the **e-stop** is released, the **motorpower** activated and the **lid** is closed.

## Regarding grip adjustment

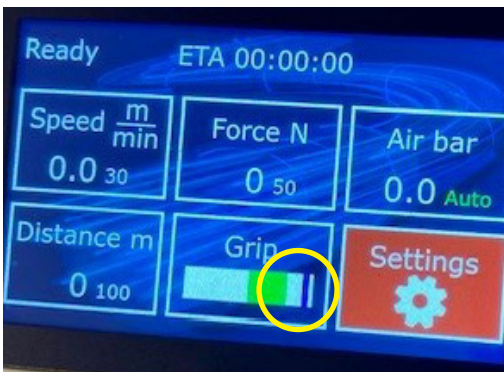

When the machine is running, the **blue bar** moves within the white field to indicate the grip level.



During the first 50 meters the operator should adjust the grip to target the blue bar within the green area to optimize the process. After the 50 meters, only minor adjustment should be made.

### Note on "Auto Air":

Once the operator has made the initial grip adjustment (during the first 50 meters), the machine will take over and adjust the air pressure automatically to maintain the correct grip level.